

SILI-S 95

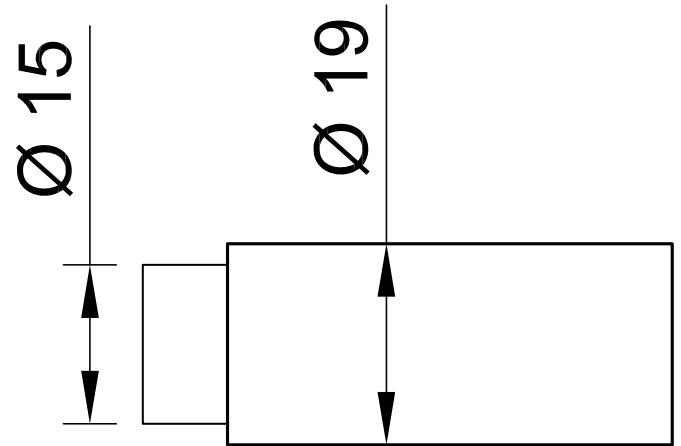
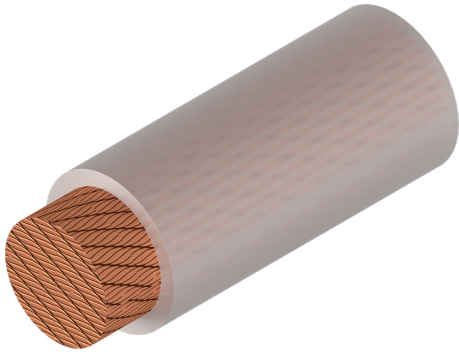

Item number 61.7619-*

Highly flexible stranded wire 95 mm² with reinforced insulation.

Technical data	
Rated Values	AC 1000 V, 290 A / DC 1500 V, 290 A
Standard color(s) *	
Lead insulation	SIL
Temperature range	-50 °C ... +90 °C
Strand design (n x Ø mm)	12103 x 0,10
Lead weight	1080.0 kg/km
Conductor diameter	15.0 mm
Cable diameter	19.0 mm
Insulation thickness	2.0 mm
Approvals	CE, UKCA, EAC