

# SILI-S 25

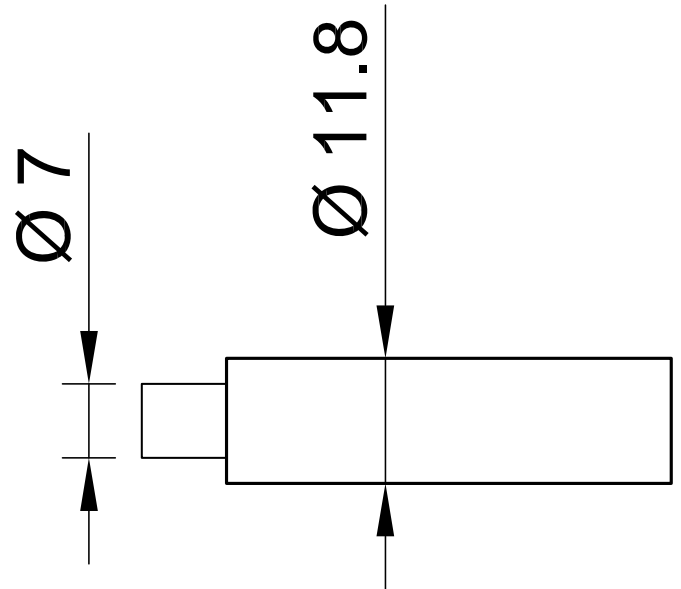
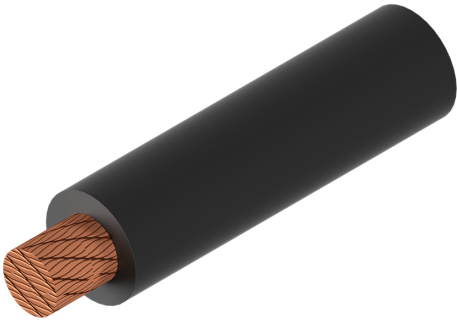

Item number 61.7615-\*

Highly flexible stranded wire 25 mm<sup>2</sup> with reinforced insulation.

Technical data	
Rated Values	AC 1000 V, 130 A / DC 1500 V, 130 A
Standard color(s) *	21 22 23 33
Lead insulation	SIL
Temperature range	-50 °C ... +90 °C
Strand design (n x Ø mm)	6384 x 0,07
Lead weight	310.0 kg/km
Conductor diameter	7.0 mm
Cable diameter	11.8 mm
Insulation thickness	2.4 mm
Approvals	UR, CE, UKCA, EAC